

**shuttle valve, screw-in
valve
BDSV-10.-3-0**



Symbol:

Nom. pressure:
350 bar

Nominal flow:
23 l/min.

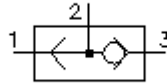

IMAV-Hydraulik GmbH
Breite Strasse 10
D-40670 Meerbusch (Osterath)
Phone +49 (0)2159 - 9188.0
Fax +49 (0)2159 - 4242
E-mail: info@imav.com
Internet: <http://www.imav.com>

CC-320-101-00
(Subject to change!)

HEX 27mm
(torque
cartridge:
48 - 54 Nm)

cavity:
C-10-3
see
data-sheet no.:
[IK-300-109-00](#)

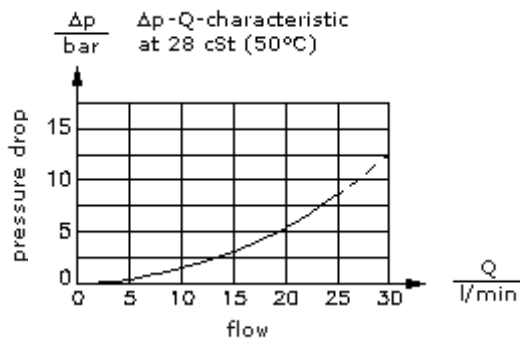
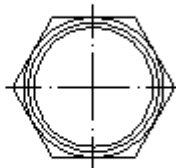
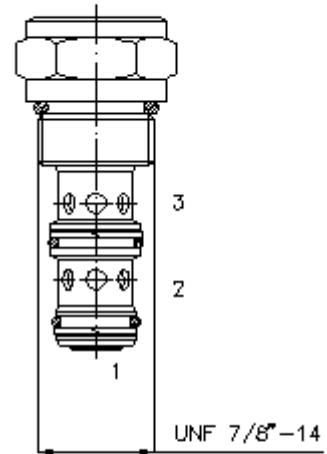
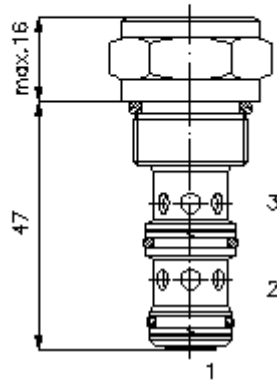

**shuttle valve, screw-in
valve
BDSV-10.-3-0**



IMAV-Hydraulik GmbH
Breite Strasse 10
D-40670 Meerbusch (Osterath)
Phone +49 (0)2159 - 9188.0
Fax +49 (0)2159 - 4242
E-mail: info@imav.com
Internet: <http://www.imav.com>

CC-320-101-00

(Subject to change!)

Ordering example:

BDSV - 10N - 3 - 0
| | | |
A **B** **C** **D**

Model code:

- | | |
|---|--|
| A design
shuttle valve
ball type | C function mode
3-way cavity |
| B size and sealing
10N = Buna (NBR)
10V = Viton (FPM) | D construction
0 = screw-in valve |

Technical Data:

nominal pressure:	350 bar
nominal flow:	23 l/min
weight:	0.11 kg
temperature range:	-40°C to 120°C
fluids:	hydraulic oil as per DIN 51524 T1 (ISO TC 131)
max. leakage:	5 drops/min at 22 cSt (50°C) and 350 bar
seals:	optional Buna (NBR) or Viton (FPM), as well as Teflon wascher (PTFE)
cavity:	C-10-3 see datasheet no. IK-300-109-00
housing:	3LH-10.-B.. see datasheet no. IH-300-000-00
seal kit:	SP-CDS-10N-32 (NBR), SP-CDS-10V-32 (FPM)