

3 way valve body

3LH-...-B..

 **Symbol:**

Nom. pressure:
350 bar

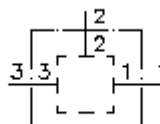

IMAV-Hydraulik GmbH
Breite Strasse 10
D-40670 Meerbusch (Osterath)
Phone +49 (0)2159 - 9188.0
Fax +49 (0)2159 - 4242
E-mail: info@imav.com
Internet: <http://www.imav.com>

IH-300-000-00
(Subject to change!)

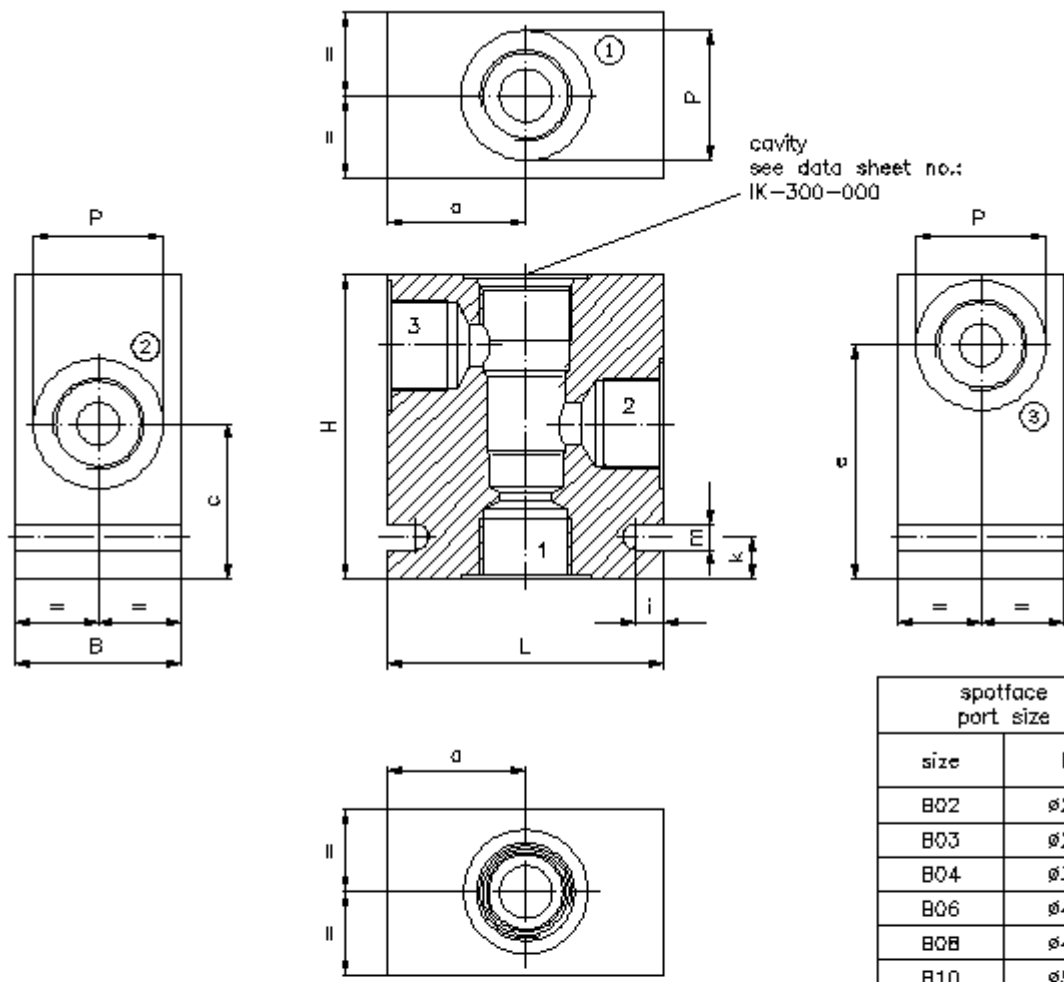

spotface port size	
size	P
B02	ø25
B03	ø28
B04	ø34
B06	ø42
B08	ø47
B10	ø58

type	L	B	H	a	c	e	i	k	m	weight (kg)	
										A	S
3LH-08.-B..	70	32	70	35	40,5	55	10	10	7	0.40	1.10
3LH-10.-B..	70	40	70	35	34,5	51	10	10	7	0.45	1.20
3LH-12.-B..	100	60	110	50	59	82	10	15	9	1.55	3.75
3LH-16.-B..	100	80	110	50	58	84.5	10	15	9	1.55	3.75
3LH-20.-B..	127	84	153	63,5	68	108,5	13,5	19	11	2.65	6.60

3 way valve body

3LH-...-B..

Ordering example:

3LH - 10 - A - B04
| | | |
A **B** **C** **D**



IMAV-Hydraulik GmbH
Breite Strasse 10
D-40670 Meerbusch (Osterath)
Phone +49 (0)2159 - 9188.0
Fax +49 (0)2159 - 4242
E-mail: info@imav.com
Internet: <http://www.imav.com>

IH-300-000-00
(Subject to change!)

Model code:

A **design**
3-way valve body

B **size**
08
10
12
16
20

C **material**
A = AlCuMgPb
S = GGG-40 resp. 9SMn28K

D **port size 1, 2 and 3**
size 08
B02 = BSPP 1/4"
B03 = BSPP 3/8"
size 10
B02 = BSPP 1/4"
B03 = BSPP 3/8"
B04 = BSPP 1/2"
size 12
B04 = BSPP 1/2"
B06 = BSPP 3/4"
B08 = BSPP 1"
size 16
B06 = BSPP 3/4"
B08 = BSPP 1"
size 20
B08 = BSPP 1"
B10 = BSPP 1 1/4"

Technical Data:

note: dimensions and weight see tabel on first page
nominal pressure: 350 bar
weight: