

3 way press.reg.screw-in valve (direct acting, adjustable) PRV1-10.-.-0-..

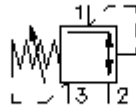

IMAV-Hydraulik GmbH
Breite Strasse 10
40670 Meerbusch - Germany
fon +49 (0)2159 - 9188.0
fax +49 (0)2159 - 4242
e-mail: info@imav.com
internet: <http://www.imav.com>

MP-210-100-00
(Subject to change!)

HEX 3/4"

HEX 1"
(torque
cartridge:
48 - 54 Nm)

cavity:
C-10-3
see
data-sheet no.:
[IK-300-109-00](#)

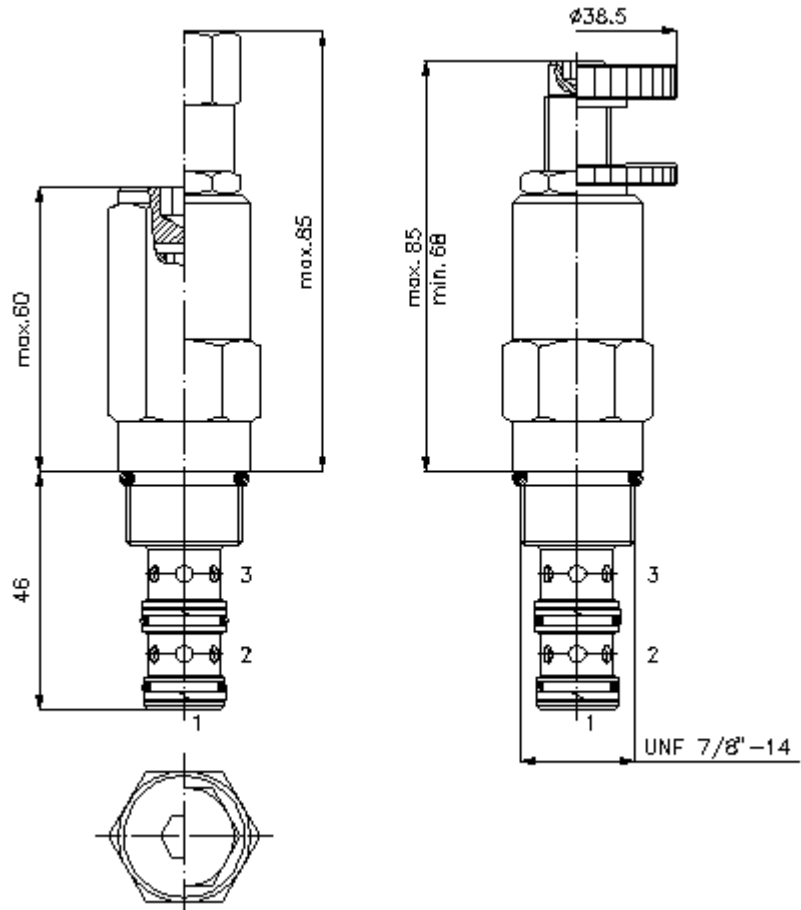

$\frac{\Delta p}{\text{bar}}$ Δp -Q-characteristic
at 22 cSt (50°C)

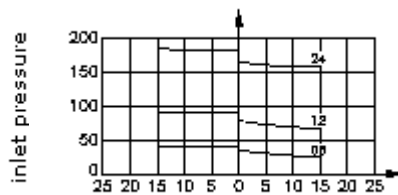

relieving 1>3

reducing 2>1

**3 way press.reg.screw-in valve
(direct acting, adjustable)
PRV1-10.-.-0-..**



IMAV-Hydraulik GmbH
Breite Strasse 10
40670 Meerbusch - Germany
fon +49 (0)2159 - 9188.0
fax +49 (0)2159 - 4242
e-mail: info@imav.com
internet: <http://www.imav.com>

MP-210-100-00

(Subject to change!)

Ordering example:

PRV1 - 10N - C - 0 - 12
| | | | |
A **B** **C** **D** **E**

Model code:

A design
pressure regulaton valve
spool type valve
direct acting

B size and sealing
10N = Buna (NBR)
10V = Viton (FPM)

C adjustment
J = internal
S = screw adjustment
C = cap
K = handknob

D construction
0 = screw-in valve

E pressure range
02 = 3.5 - 14 bar
06 = 7.0 - 40 bar
12 = 14.0 - 85 bar
24 = 30.0 - 165 bar

Technical Data:

nominal pressure: 165 bar
nominal flow: 15 l/min
weight: 0.24 kg
temperature range: -40°C to 120°C
fluids: hydraulic oil as per DIN 51524 T1 (ISO TC 131)
seals: optional Buna (NBR) or Viton (FPM), as well as Teflon wascher (PTFE)
cavity: C-10-3 see datasheet no. [IK-300-109-00](#)
housing: 3LH-10.-B.. see datasheet no. [IH-300-000-00](#)
seal kit: SP-MDS-10N-32 (NBR), SP-MDS-10V-32 (FPM)